

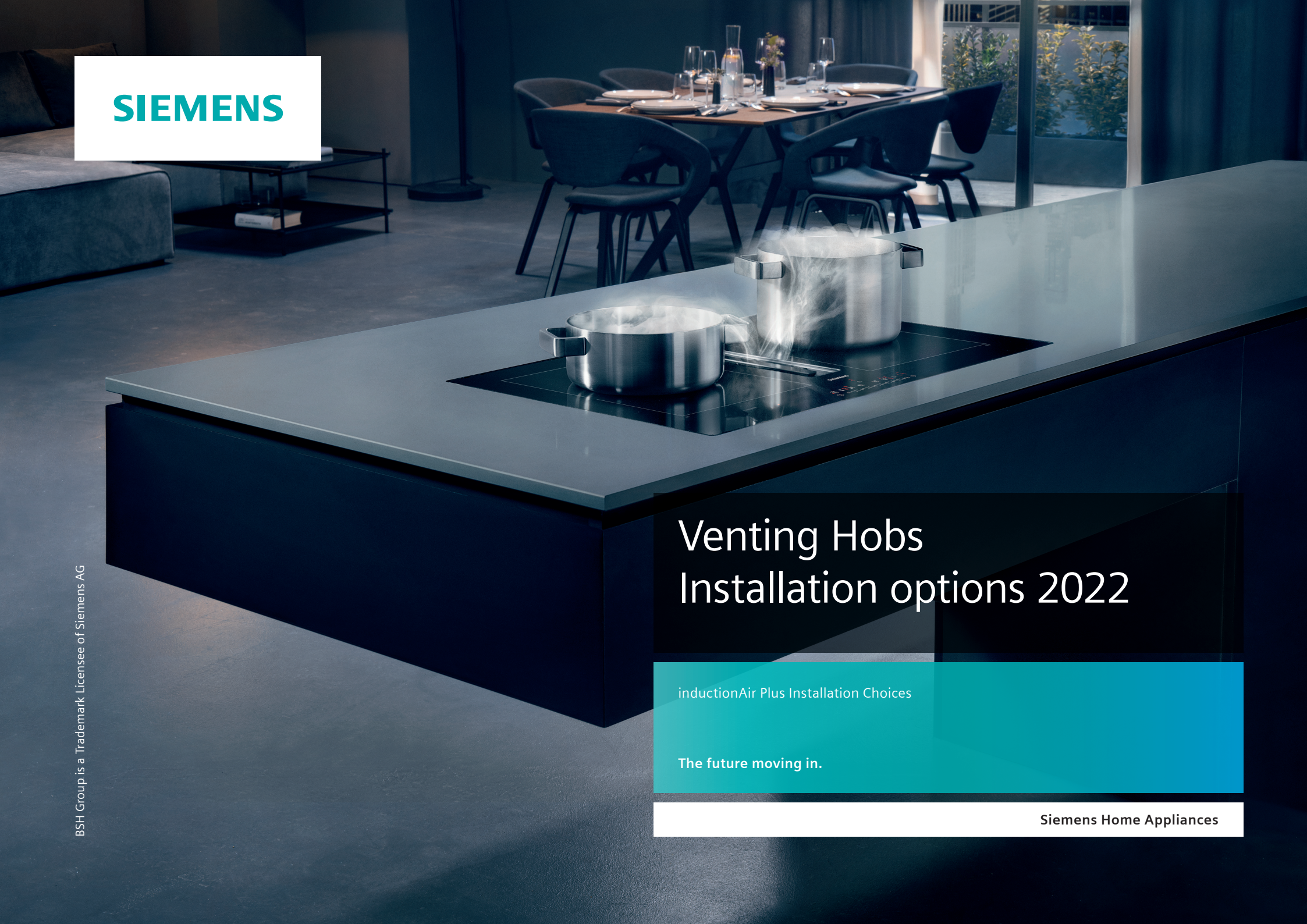

SIEMENS



Venting Hobs Installation options 2022

inductionAir Plus Installation Choices

The future moving in.

Siemens Home Appliances

Explore the science of inductionAir Plus cooking.

Combining induction technology with powerful extraction, the inductionAir Plus hob is intelligently designed for your kitchen.

inductionAir Plus hob

The inductionAir Plus hob gives you the freedom to style your kitchen how you want to, with the added benefit of hassle-free cleaning. The innovative design means that the grease filters fit into an entirely detachable liquid tray unit which is made to completely protect against spillages and over-boiled liquids.

How does it work?

All parts of the inductionAir Plus hob are neatly arranged in a liquid tray unit, accessed from the top of the hob. Each part is dishwasher-proof, including the black glass air inlet grid, the 2-in-1 grease filter and the liquid tray. Each part is also separate to save space in your dishwasher.

Protects from spills

As a first layer of protection, the black glass air inlet grid is designed to limit the flow of liquids into the ventilation module. As a second layer of protection, the liquid tray captures up to 200ml from day-to-day cooking and can be easily discarded. In addition, up to 700ml of additional liquid can be held in the liquid safety tank accessed from beneath the appliance, and safe-guarding it from damage. This means you can focus on your cooking with complete peace of mind.

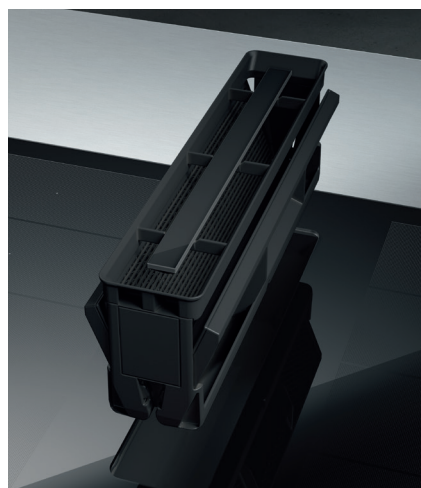

Find the perfect fit for your kitchen.

Size flexibility

The inductionAir Plus hob comes in 3 variants of size: 60cm, 70cm and 80cm. This means that, with whatever space you have, there is an inductionAir Plus hob that will fit perfectly into your kitchen.

Installation options

There are 4 different ways to install the inductionAir Plus hob, giving you plenty of options as to how and where to install it.

See page 9 within the Product installation guide for an outline of installation options and accessory requirements.

Model shown:
ED851FQ15E inductionAir Plus hob

Unducted Recirculation

Choosing The Correct Installation Mode

INSTALLATION CONSIDERATIONS

What Do I Need?

4 cleanAir filters and telescopic slider.

These are supplied as standard with all inductionAir Plus appliances

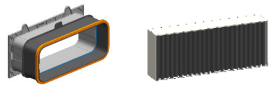

Good To Know

Telescopic slider ventilates air from the appliance into the service void. Max expansion of slider 80mm

Min requirement of service void 25mm, recommended 50mm min.

Important To Note

This option is **NOT** suitable for installations with non insulated walls

This is the **ONLY** installation type that uses the telescopic slider

WHY USE THIS?

Easy and quick to fit

Less parts

Cost effective

Requires **no reduction** in depth to the bottom two drawers and allows for more design flexibility for example **floating islands**.

Automatic run on of the extractor fan at min power level dries the filters and continues air flow through the service void, removing any potential moisture for extra safety

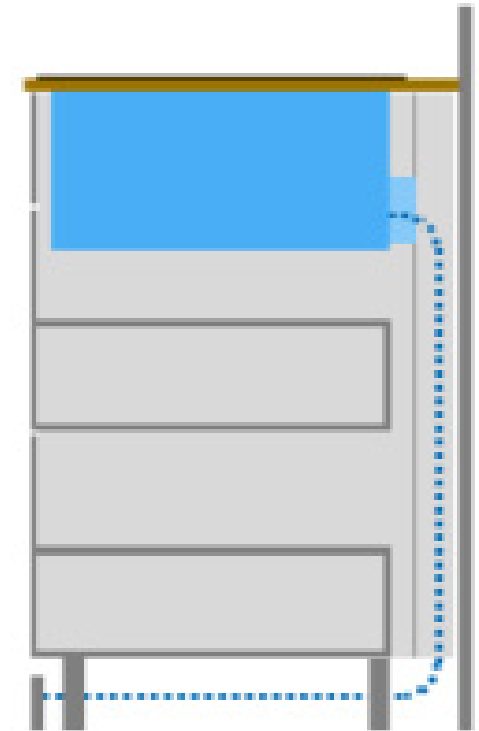

Full Depth Drawers Possible

Partly Ducted Recirculation

Choosing The Correct Installation Mode

INSTALLATION CONSIDERATIONS

What Do I Need?

4 x cleanAir re-circulating filters. Supplied with appliance
Starter Kit 1 HZ9VDKR0 or 2 HZ9VDKR1 depending on the work surface depth

Good To Know

Partly Ducted Recirculation takes the air down into the plinth and ventilates in through the plinth cavity.

This requires greater depth worktop of reduced depth drawers.

The 94mm ducting height cannot be changed to a slimmer version (Reduces effectiveness) using an adaptor, as the 94mm space is still needed for the 90 degree turn from the horizontal to the vertical.

Important To Note

Starter Kits 1 and 2 provide all the required ducting and connectors for this mode of installation

The appliance maybe fitted with another manufactures ducting that has a rounded radius (Please check compatibility before purchase) You will still need to purchase a (HZ9VDSM1) diffuser

WHY USE THIS?

Required when the distance from the back of the appliance to back of the base unit void is greater than 80mm

Suitable for installations with non insulated walls or where damp has been an issue

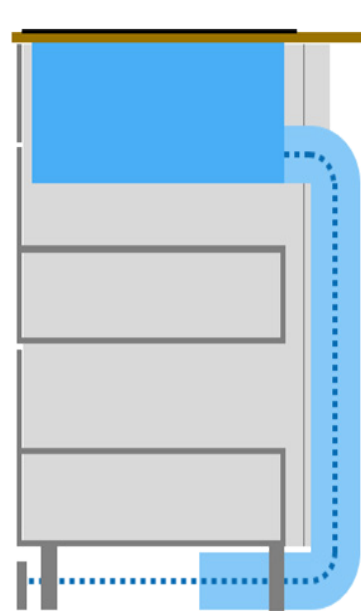

Maximum drawer depth 513mm with 70+ worktop

Fully Ducted Recirculation

Choosing The Correct Installation Mode

INSTALLATION CONSIDERATIONS

What Do I Need?

4 x cleanAir re-circulating filters. Supplied with appliance

Starter Kit 1 **HZ9VDKR0** or 2 **HZ9VDKR1** depending on the work surface depth

To fully duct to the plinth an additional straight channel and a connector are required. A 500mm ducting section should be sufficient in most cases depending on worktop depth

Good To Know

Full Recirculation kit takes air down through the plinth and out into the room via a plinth vent.

This requires greater depth or reduced depth drawers

The 94mm ducting height cannot be changed to a slimmer version (reduces effectiveness) using an adaptor, as the 94mm space is still needed for the 90 degree turn from the horizontal to the vertical.

Important To Note

The appliance maybe fitted with another manufactures ducting that has a rounded radius (Please check compatibility before purchase) You will still need to purchase a (**HZ9VDSM1**) diffusor

WHY USE THIS?

Required when the distance from the back of the appliance to back of the base unit void is greater than 80mm

Gives total peace of mind for non insulated walls or where damp has been an issue

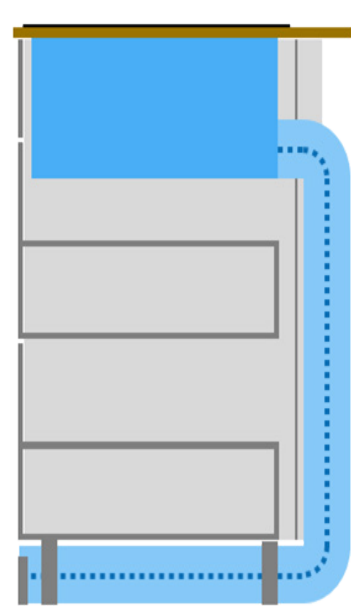

Maximum drawer depth 513mm with 70+ worktop

Ducted Out

Choosing The Correct Installation Mode

INSTALLATION CONSIDERATIONS

What Do I Need?

Starter Kit 3 **HZ9VDKE1** (Includes 4 acoustic filters, radius bend, connector and 50cm straight channel)

To complete your installation we can provide additional ducting lengths, connectors and adaptors

Good To Know

It is also possible to use a fully ducted system, out of the kitchen.

The acoustic filter kit is still required and is accessed the same way as the recirculation options

The **inductionAir Plus** has been tested with a ducting run of **8 metres** with **3 x 90** degree turns and it maintaining efficient performance.

We don't currently offer an external grid to go on the outside wall – this needs to be sourced independently

Important To Note

The appliance maybe fitted with another manufactures ducting that has a rounded radius (Please check compatibility before purchase)
You will still need to purchase (**HZ9VEDU0**) acoustic filters x 4

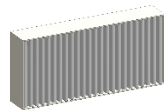

WHY USE THIS?

Allows the removal of heat and moisture created by cooking, as well as grease and odour

An improvement of extraction rate over recirculation modes * **615m3h** recirculation **622m3h** ducted out

*As per test parameters for the energy label declaration

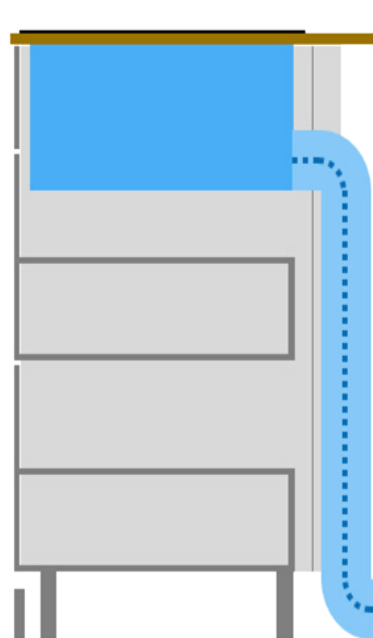

Venting Hobs: Installation options

Effective – January 2022

Installation Kit Choices

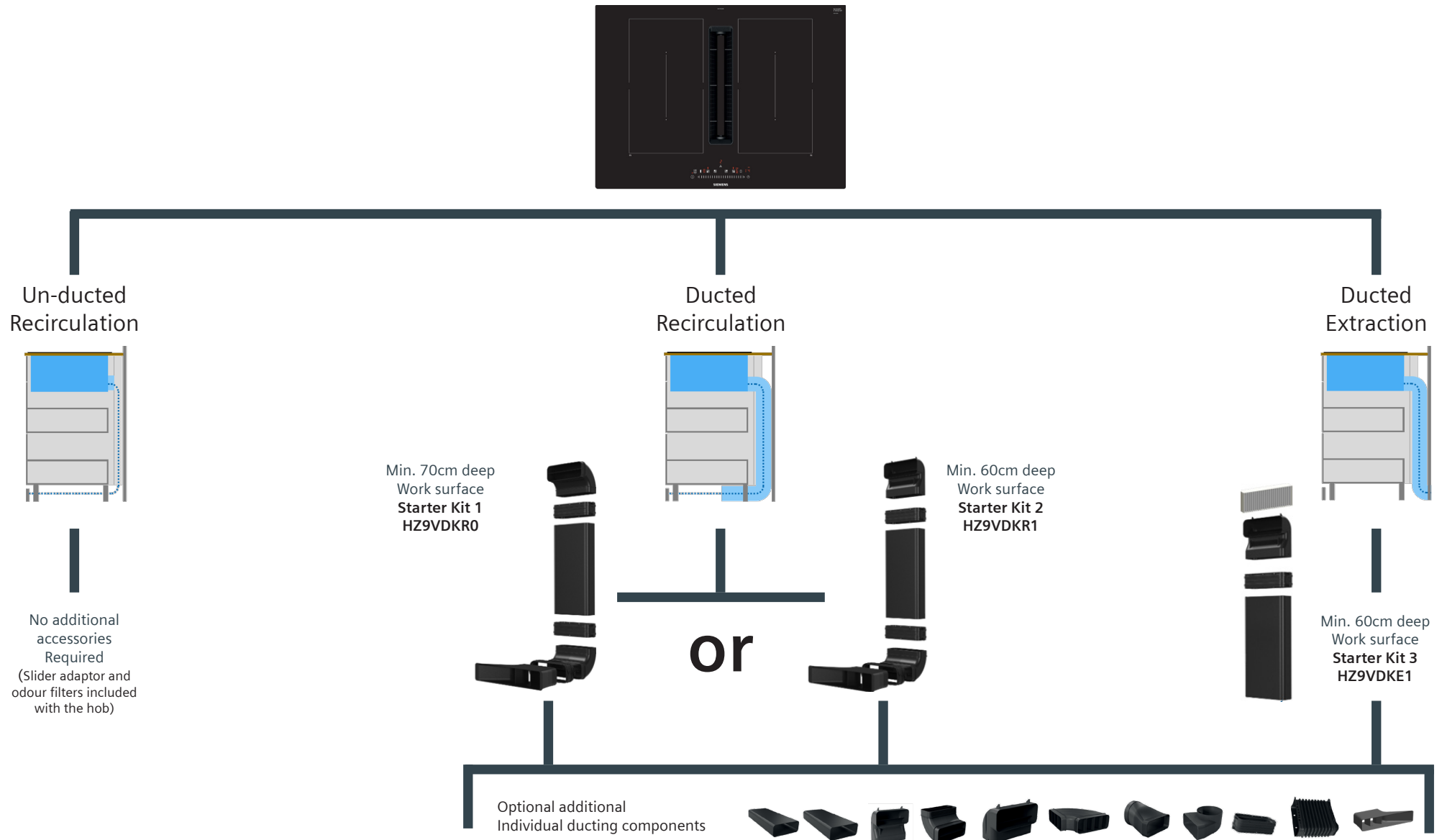

Note: when installing using worktop depth of less than 70cm, reduced depth drawers may be necessary

For
Un-ducted
Recirculation

Kit Contents

Images

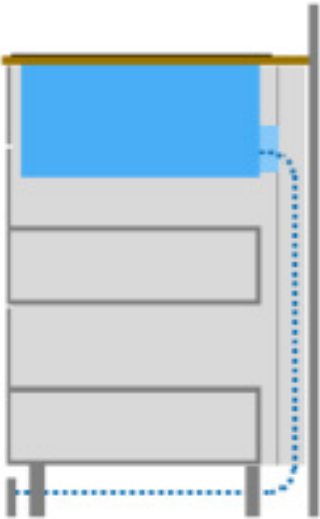

Standard Kit
4 x cleanAir
recirculating filters
(HZ9VRCR0)
Telescopic slider

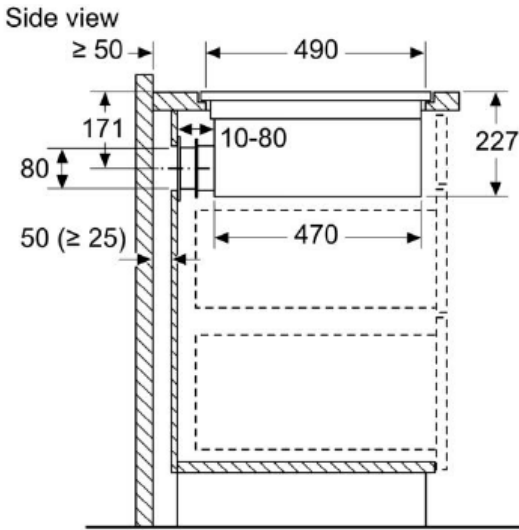

Measurement in mm

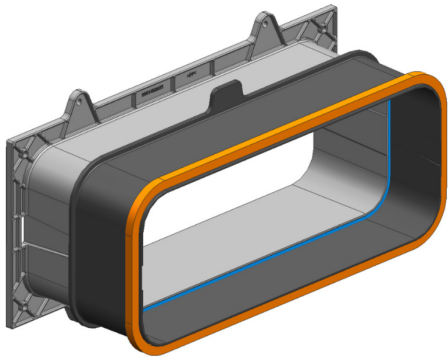

The telescopic slider is self gluing and opens to a maximum of 80mm

Partly or fully ducted recirculation

Kit Contents

Images

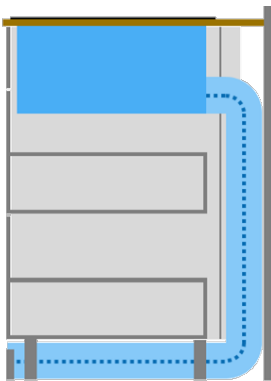
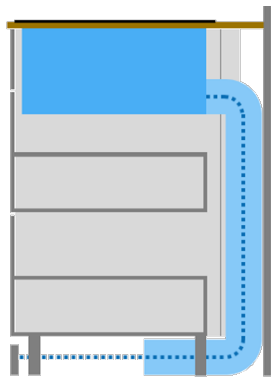

HEZ9VDKR0

- 2 x Large radius bends (HEZ9VDSB2)
- 3 x connectors (HEZ9VDS1)
- 1 x 50cm straight channel (HEZ9VDSM1)
- 1 x diffuser (HEZ9VRPD1)

Install the filters into the hob (included with venting hob)

Use the adhesive to seal the first bend into the back of the hob

Discard the telescopic slider piece included with venting hob

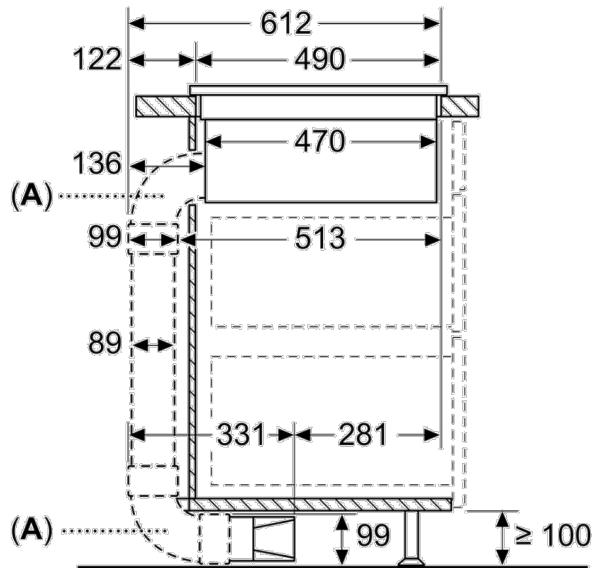

A: With 90° "L" bows

Measurement in mm



Note: To fully duct to the plinth additional straight channel and a connector are required

HEZ9VDKR1: Starter kit for Ducted recirculation for min. 60cm worktop depth

Partly or fully ducted recirculation

Kit Contents

Images

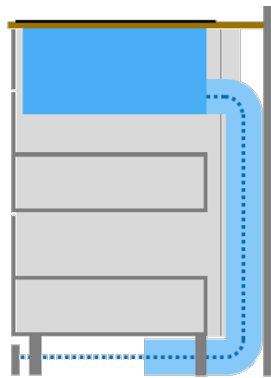

HEZ9VDKR1

- 1 x Small radius bend (HEZ9VDSB4)
- 1 x Large radius bend (HEZ9VDSB2)
- 3 x connectors (HEZ9VDSS1)
- 1 x 50cm straight channel (HEZ9VDSM1)
- 1 x diffuser (HEZ9VRPD1)

Install the filters into the hob (included with venting hob)

Use the adhesive to seal the first bend into the back of the hob

Discard the telescopic slider piece included with venting hob

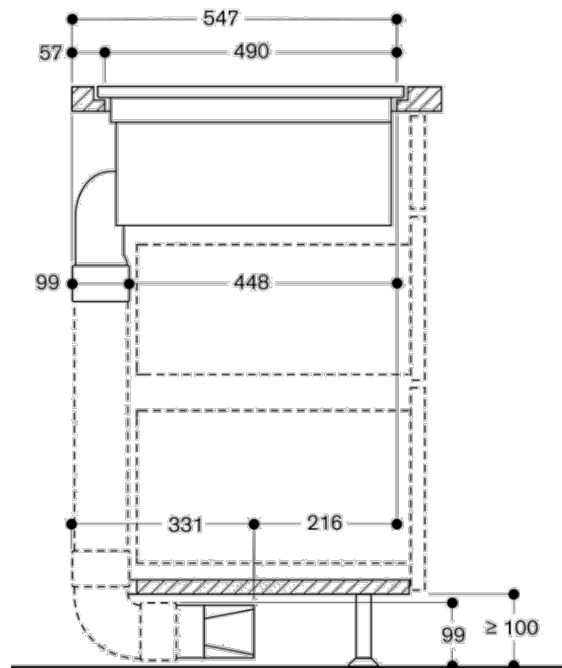
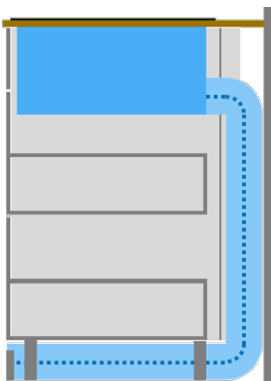

Measurement in mm

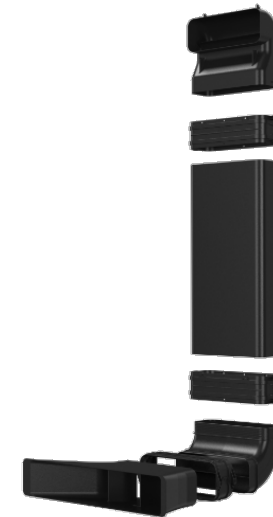

To fully duct to the plinth additional straight channel and a connector are required

HEZ9VDKE1: Starter kit for ducted exhaust extraction in min. 60cm worktop depth

For
Fully Ducted
Out Extraction

Kit Contents

Images

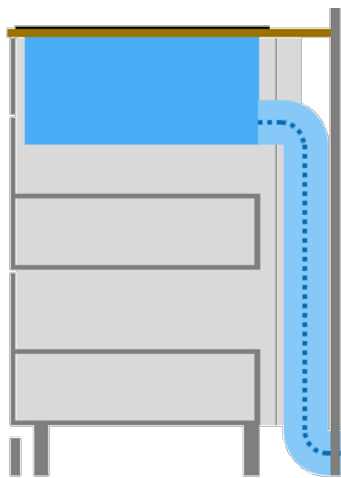

HEZ9VDKE1

- 1 x Small radius bend (HEZ9VDSB4)
- 1 x connector (HEZ9VDSS1)
- 1 x 50cm straight channel (HEZ9VDSM1)
- 1 x set of 4 acoustic filters

Install acoustic filters into the hob

Use the adhesive to seal the first bend into the back of the hob

Discard the clean air filters and telescopic slider included with the venting hob

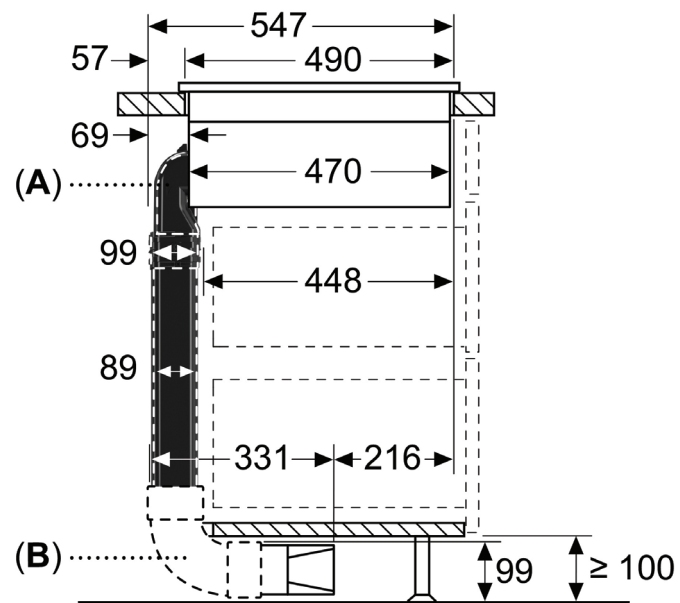



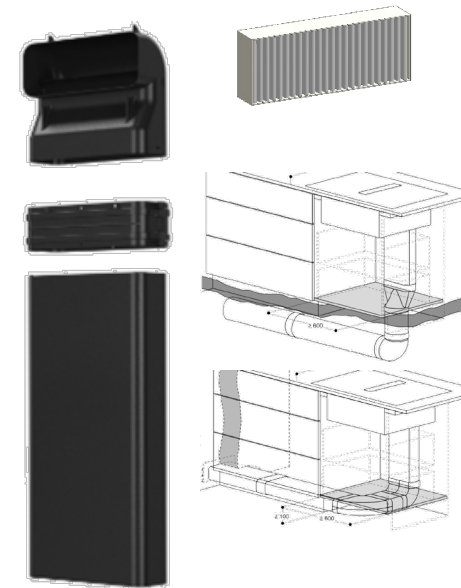

Measurement in mm



From this point, additional individual ducting components are required (Installation specific).

Optional additional individual ducting components

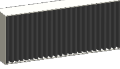
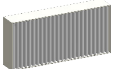
	HZ9VDSM1	500mm long flat channel ducting section – outlet size 222mm x 89mm
	HZ9VDSM2	1000mm long flat channel ducting section – outlet size 222mm x 89mm
	HZ9VDSB1	Flat channel 90° horizontal bend, for worktop depth minimum 65cm - outlet size: 222mm x 89mm
	HZ9VDSB2	Flat channel 90° vertical bend (large Radius), for worktop depth minimum 70cm - outlet size 222mm x 89mm
	HZ9VDSB4	Flat channel 90° vertical bend (medium Radius), for worktop depth minimum 65cm - outlet size: 222mm x 89mm
	HZ9VDSB4	Flat channel 90° vertical bend (short Radius), for worktop depth minimum 60cm - outlet size 222mm x 89mm
	HZ9VDSS1	Connection piece for use between straight channel ducting components and bends - outlet size: 222mm x 89mm
	HZ9VDSS2	Flexible Connection piece for use between straight channel ducting components and bends - outlet size: 222mm x 89mm
	HZ9VDSIO	Straight Adaptor / Converter flat to round (Ø 150mm) - outlet size: 222mm x 89mm
	HZ9VDSI1	90° Adaptor / Converter flat to round (Ø 150mm) - outlet size: 222mm x 89mm
	HZ9VRPD1	Diffusor for ducted recirculation - outlet size: 222mm x 89mm
	HZ9VRCR0	1 x set of cleanAir recirculation filters
	HZ9VEDU0	1 x set of Acoustic filters

